

**Customer Information**

Full Name: \_\_\_\_\_ Date: \_\_\_\_\_

*Last First M.I.*

Address: \_\_\_\_\_

*Street Address Apartment/Unit #*

*City State ZIP Code*

Phone: (    ) E-mail Address: \_\_\_\_\_

Existing or new cabinets? \_\_\_\_\_ Previous Customer? \_\_\_\_\_ Estimate Budget: \$ \_\_\_\_\_

**How Did You Hear About Us?**

- |                     |                          |                  |                          |
|---------------------|--------------------------|------------------|--------------------------|
| Google, Yahoo, MSN? | <input type="checkbox"/> | Repeat Customer? | <input type="checkbox"/> |
| Phone Book?         | <input type="checkbox"/> | Referred By?     |                          |
| Newspaper?          | <input type="checkbox"/> | Other?           |                          |

**Project Information**

Backsplash height: \_\_\_\_\_ (Note: use inches and typical height is 4")

- Sink Type:**
- Drop In
  - Undermount
  - Farm Sink

**FAX THIS PAGE AND YOUR DRAWING TO 518-681-3053**

Or email to [adkgranite@gmail.com](mailto:adkgranite@gmail.com)

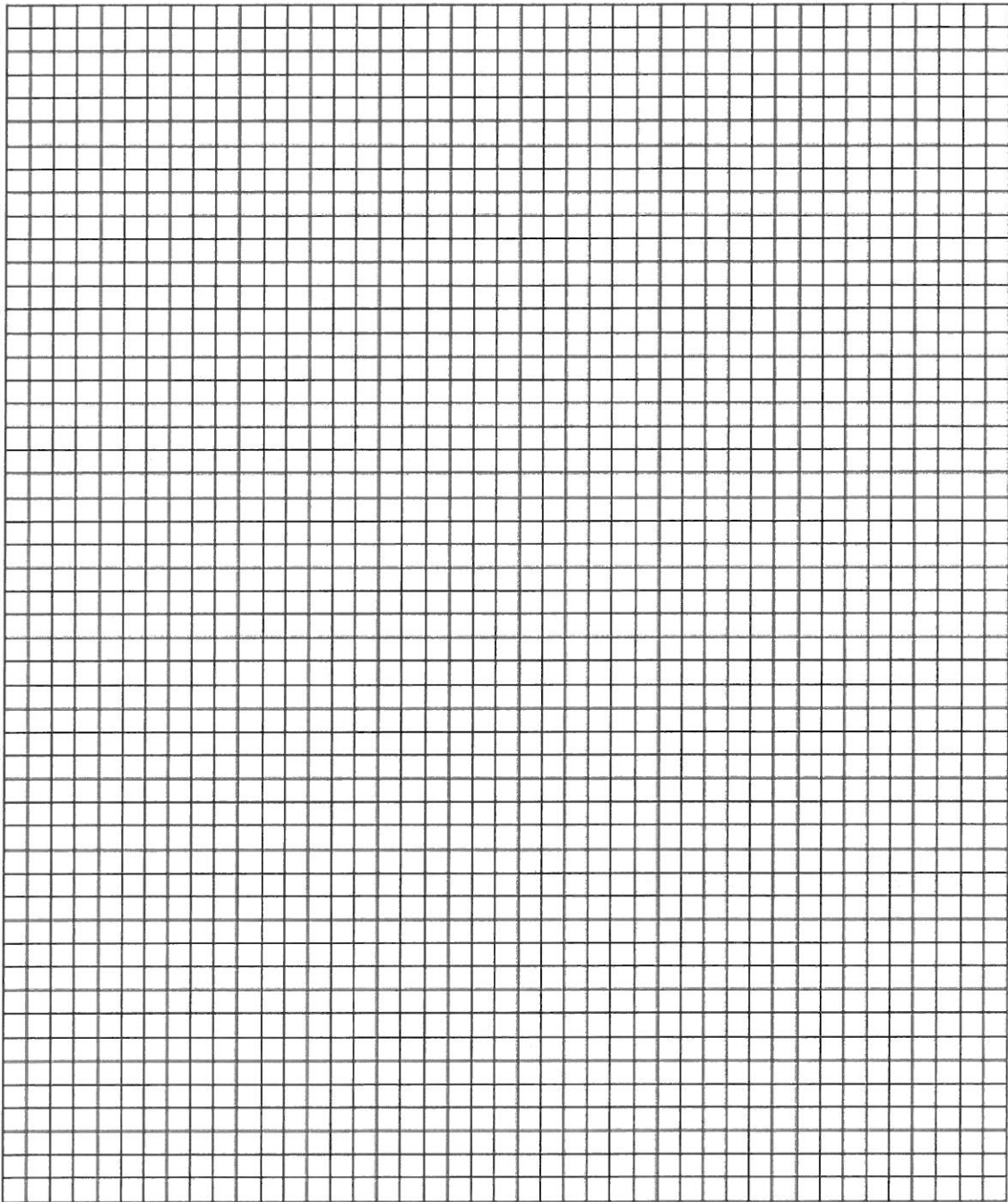

Draw your project or layout. Indicate measurements & sink, cook top or stove locations. Mark edge profile areas with a "P" and backsplash areas with "B/S". Most kitchen countertop depths are approx.  $25 \frac{1}{2}$ ". The rule of thumb is most cabinets are  $24" + 1 \frac{1}{2}"$  for overhang on the front results in  $25 \frac{1}{2}"$ .

ADIRONDACK PRECISION CUT STONE

We finish what nature started...

Please do not hesitate to call our office for assistance at 518-681-3008

SAMPLE

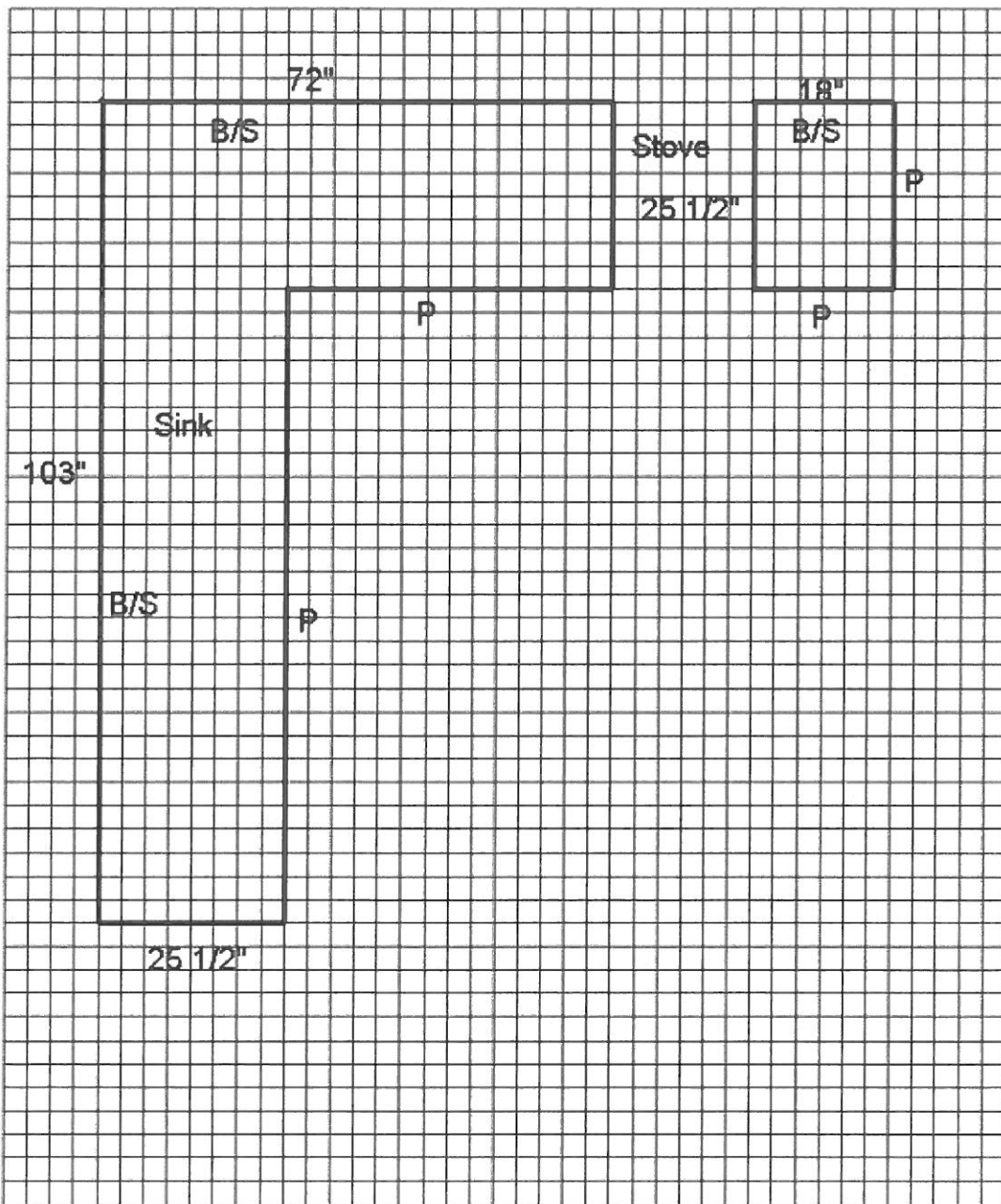

This sample drawing shows a kitchen with general sink and stove location.